

Office SF = 604
 Warehouse SF = 1,201
 Total RSF = 1,805

NOTE:
 Overlying grid is 2' x 2'
 Not to scale.

 Air Conditioned Area

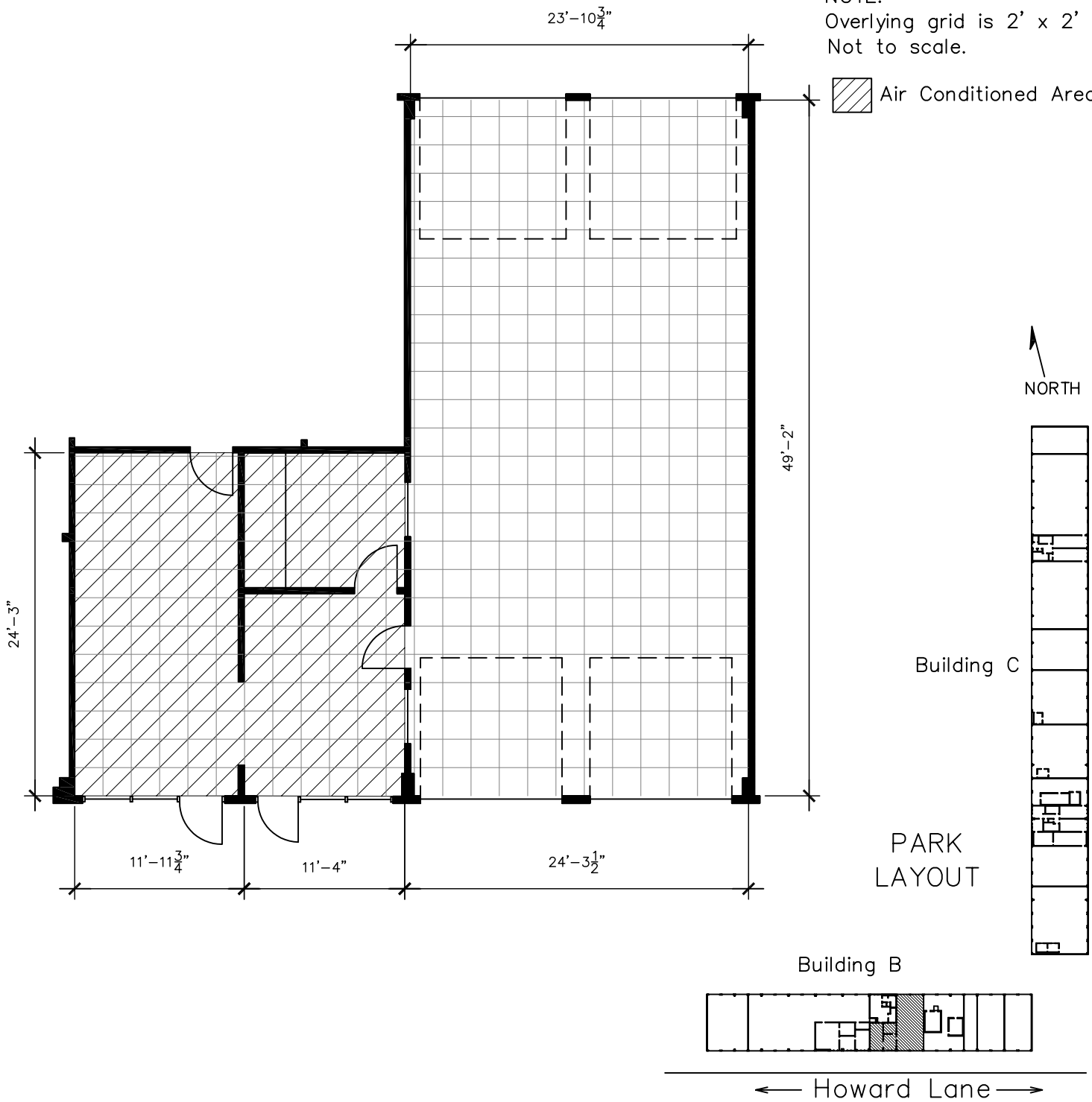

Drawing for:
LH. LAYNE COMPANY
 404 W. Powell, Ste. 202
 Austin, Texas 78753
 Ph: 252-9900 Fax: 252-9902

BLDG. B SUITE 9-11A
 HOWARD ROUTE CENTER
 1120 W. HOWARD LN.
 RENTABLE AREA: 1,805 S.F.

THE MEASUREMENTS AND FLOOR PLANS ARE ACCURATE TO WITHIN 2% INTERIOR WALLS AND DEMISING WALLS ARE ASSUMED TO BE 5" THICK.
 Project No.: 20306.06
 Rev. Date: Jan. 19, 2009
 ©2009

+ DIMENSIONS +
FLOOR PLANS
 4412 Spicewood Spgs. Rd., Ste. 803
 Austin, Texas 78759
 Phone: 342-0114 Fax: 342-1965